

GENERAL NOTES:

1. Base information including topography, grading, utilities, building and existing vegetation location prepared by Ewing Prop. LLC.
2. This plan is for landscaping purposes only.
3. The Landscape Architect's seal applies only to the landscape portion of this plan.
4. See sheet LP-7 for planting notes and details.
5. All plant material is to be field adjusted as necessary to address existing site conditions, proposed unit landscaping, and to ensure that clear sight triangles and clear sight lines are maintained.
6. Proposed shade trees shall not be planted over the top of any sewer or water laterals, mains or services. Sewer and water laterals, mains and services are shown on Landscape Plans for reference only. See engineers plans for location of all utilities.
7. Shade and evergreen trees shall be planted fifteen (15) feet from overhead utility lines or light standards. Utilities are shown on Landscape Plans for reference only. See engineers plans for location of all utilities.
8. No planting shall be installed closer than five (5) feet to any property line.
9. All plantings shall be permanently maintained.
10. All trees shall be pruned as necessary to maintain required light levels.
11. Lawn areas around the buildings will be sod and an automatic sprinkler system will be installed for the lawn. An automated drip irrigation system will be installed in planting beds around the building for foundation plantings.

NOTE:
See sheets LP-2 through LP-5 for 20 scale landscape plans.

LEGEND:

- EXISTING VEGETATION
- PROPOSED DECIDUOUS TREE
- PROPOSED ORNAMENTAL TREE
- PROPOSED MULTI-STEM TREE
- PROPOSED EVERGREEN TREE
- PROPOSED SHRUBS
- PROPOSED GROUNDCOVERS AND PERENNIALS

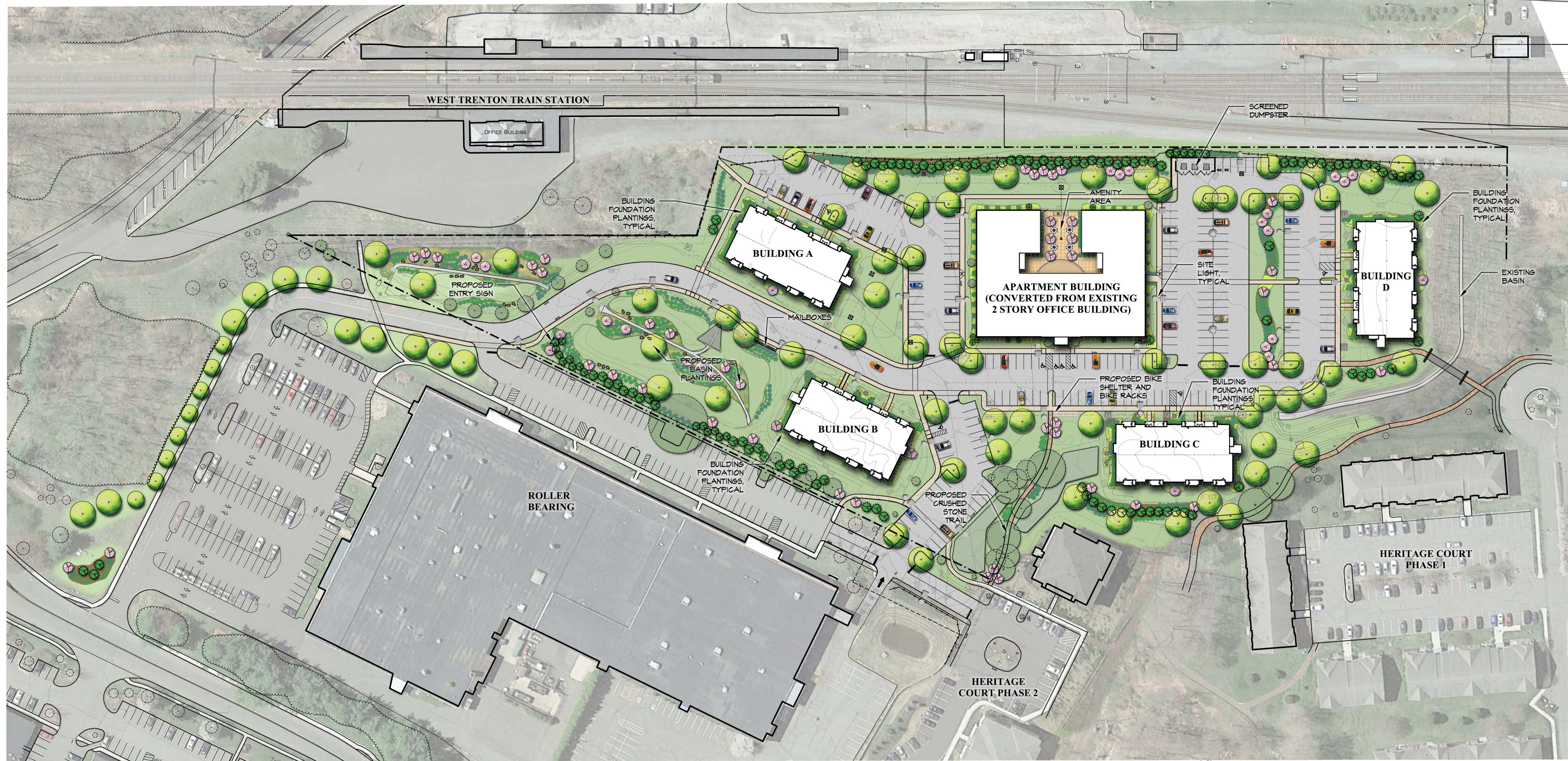

PRELIMINARY AND FINAL LANDSCAPE PLAN
Heritage Court Phase 3
EWING TOWNSHIP, MERCER COUNTY, NEW JERSEY

DATE: 03/24/2021 (mc)
REV.: 07/02/2021 (gs)

PROJECT #: 20-074

Overall
Landscape
Plan

SHEET:

LP-1

CALL BEFORE YOU DIG!
NEW JERSEY LAW REQUIRES
3 BUSINESS DAYS IN ADVANCE
OF SPECIFIED DIG START DATE.

POCS SERIAL NUMBER _____
1-800-272-1000

