

**CONSTRUCTION NOTES:**

- REPLACE WALK AS DIRECTED BY TWP ENGINEER
- REPAIR EXISTING INLET AND SIDEWALK AS DIRECTED BY TOWNSHIP

**PLANTING SCHEDULE**

3. SCREENING :-  
 NS - NORWAY SPRUCE - PICEA ABIES : 4' TO 5' PLANTING HEIGHT 3 REQ  
 SB - (SERVICEBERRY) ; ANELANCHIER LAEVIS 6"-7" MULTI-STEMS 3 REQUIRED 48" HEIGHT

PR - P.J.M RHODOENDRON - 13 REQ - 20"-24"  
 AH - AMERICAN HOLLY - 8 REQ - 20"-24"  
 LP - LONDON PLANE 3" CALIPER 3 REQ

4. STREET TREES - AR - ACER RUBRUM (RED GLORY MAPLE) 2 REQ 3" CALIPER

6. COLLECT ALL ROOF DRAINS TO 6" PVC OR SDR-25 PIPE TO DRYWELL AS INDICATED

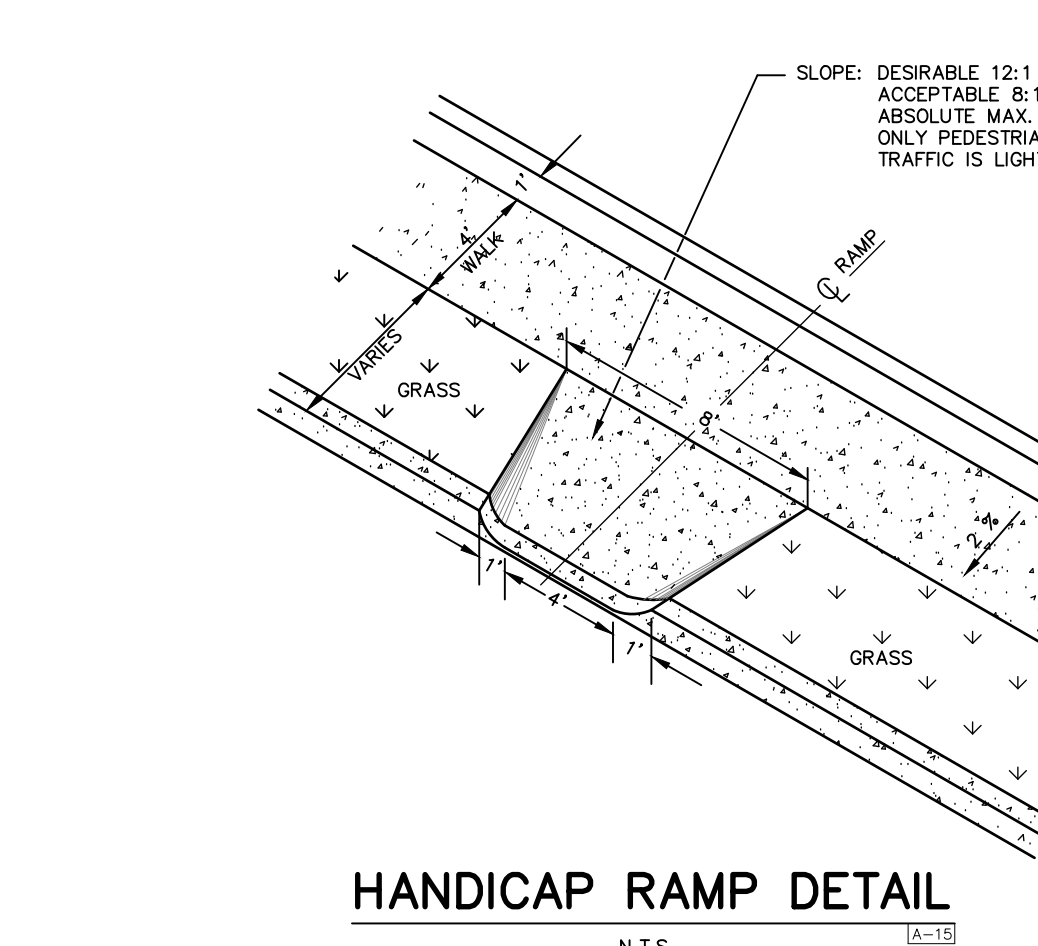
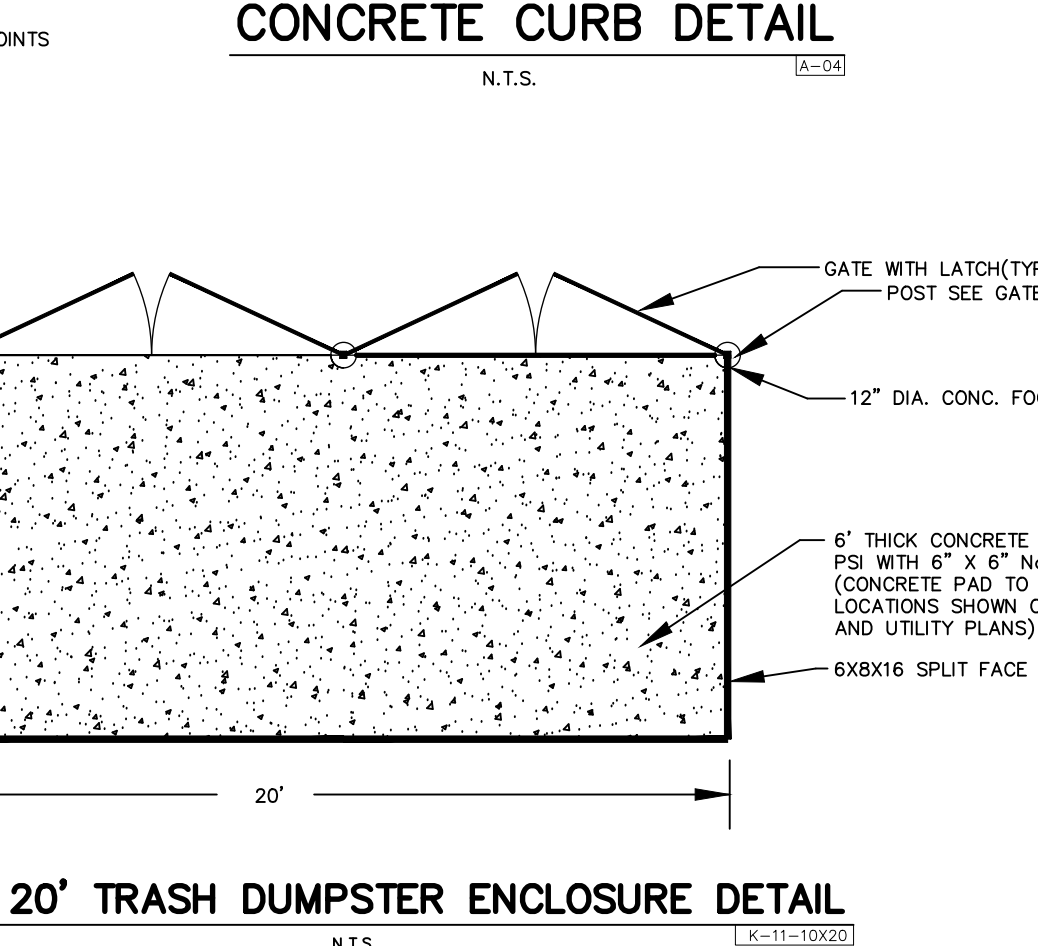
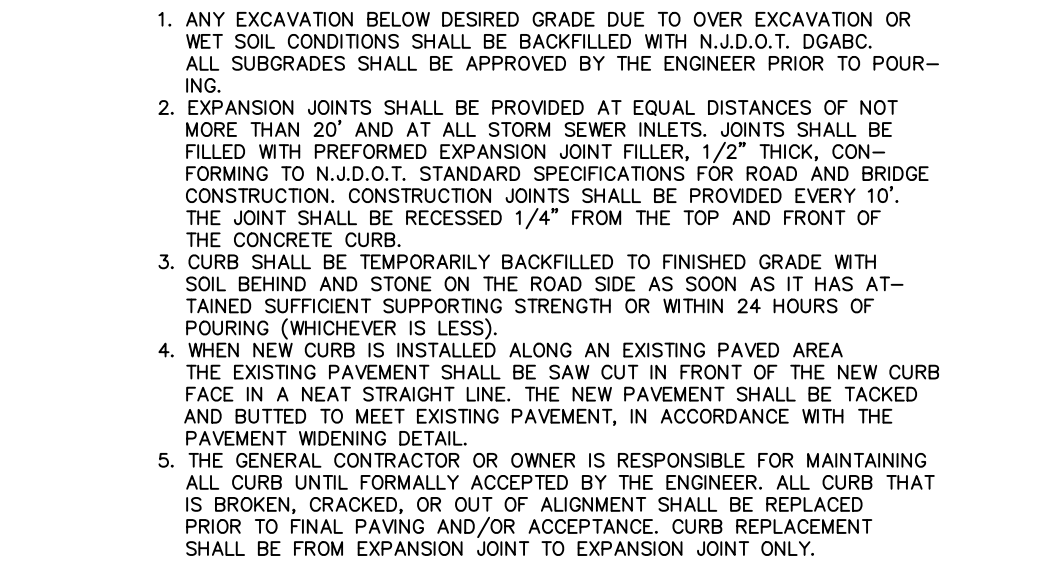
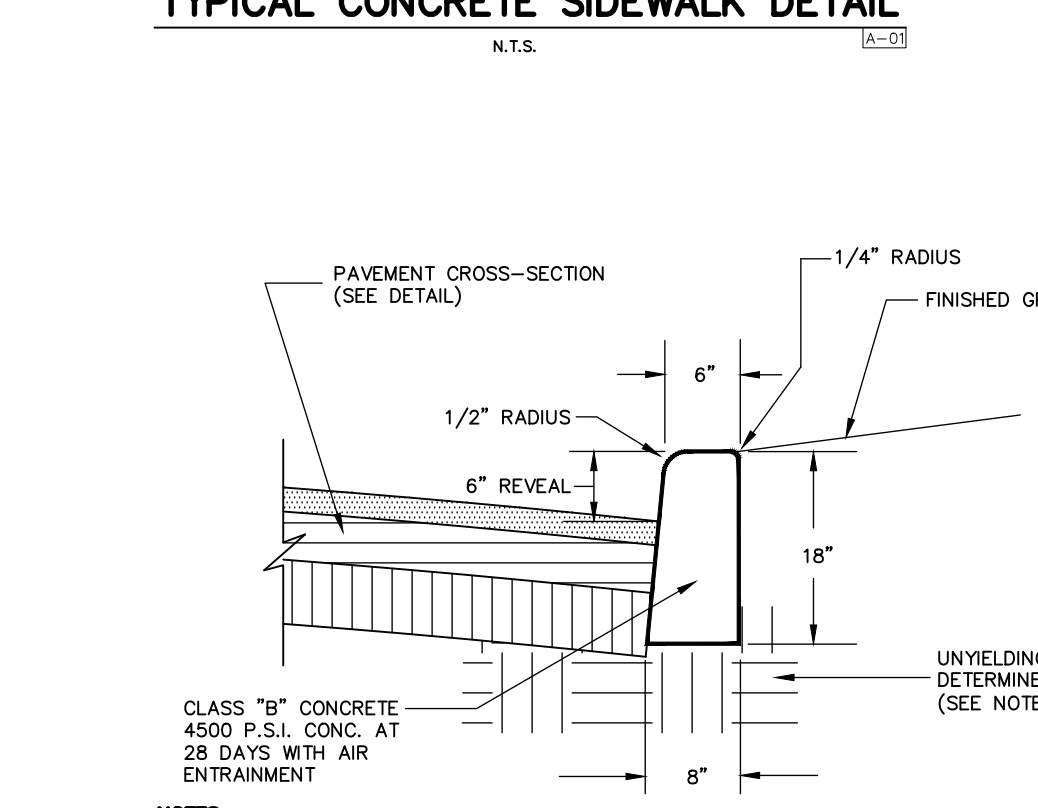
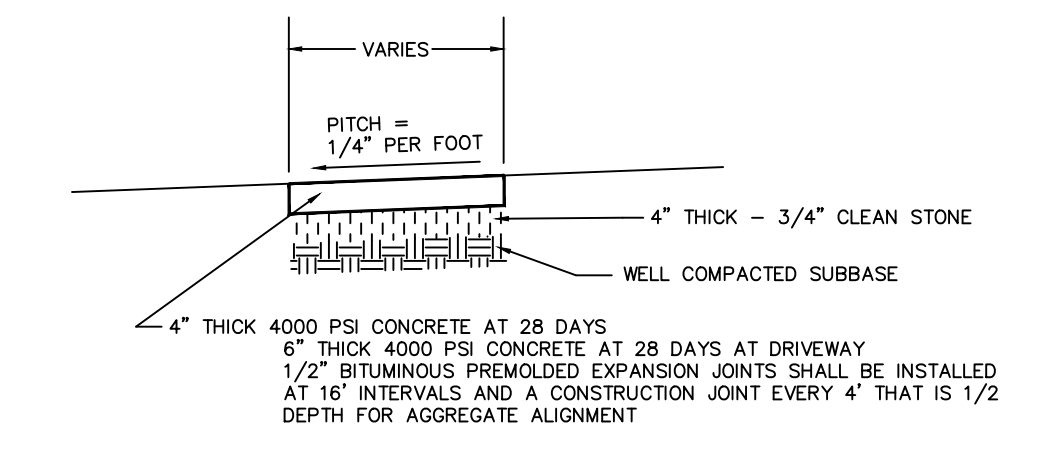
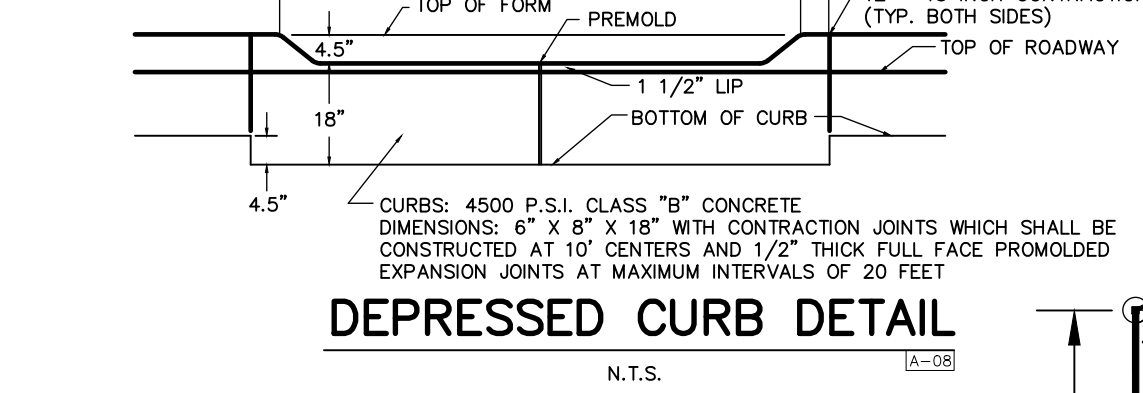
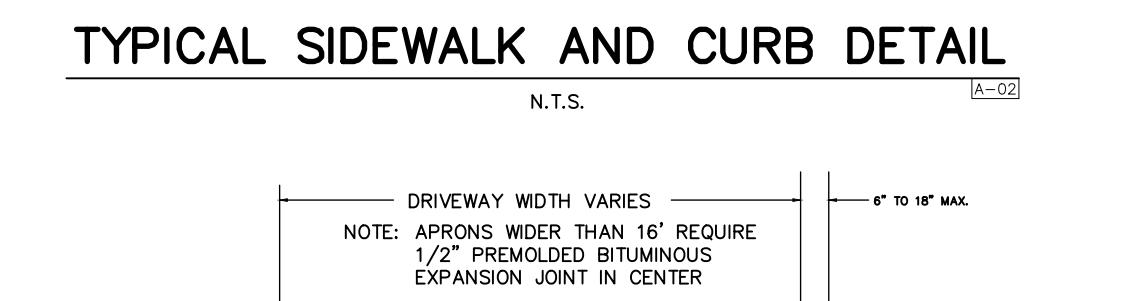
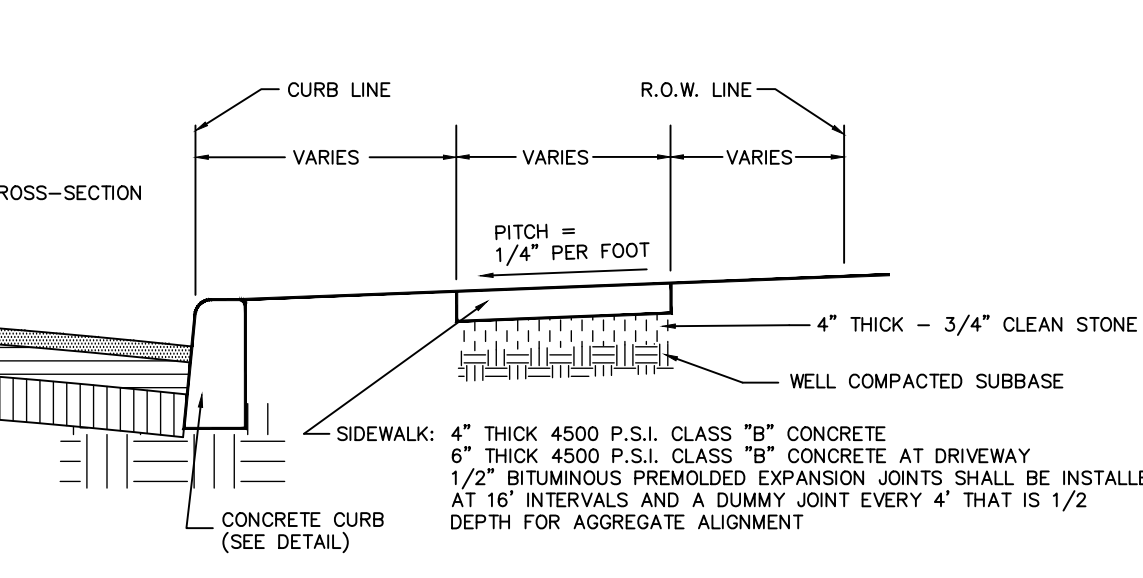
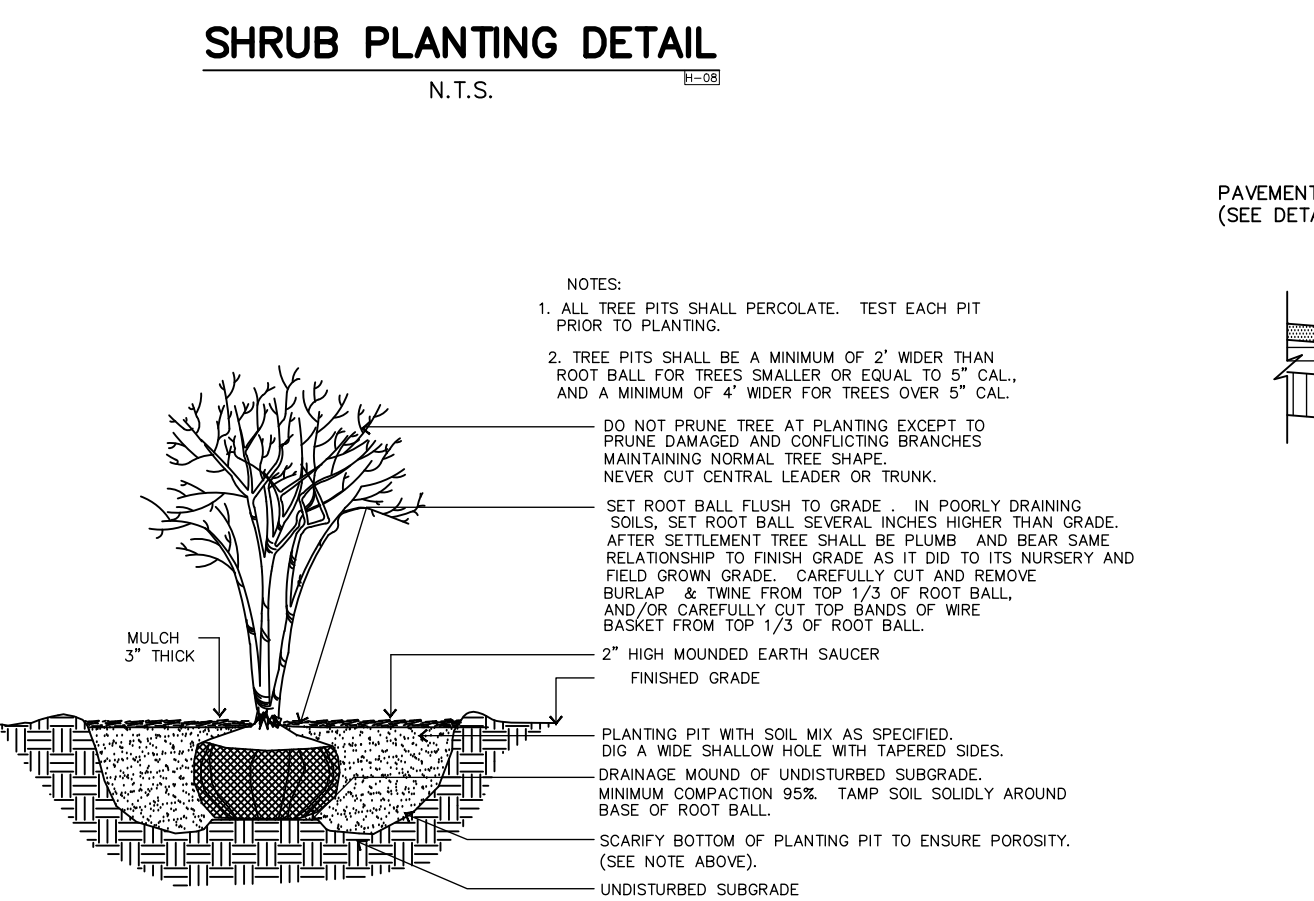
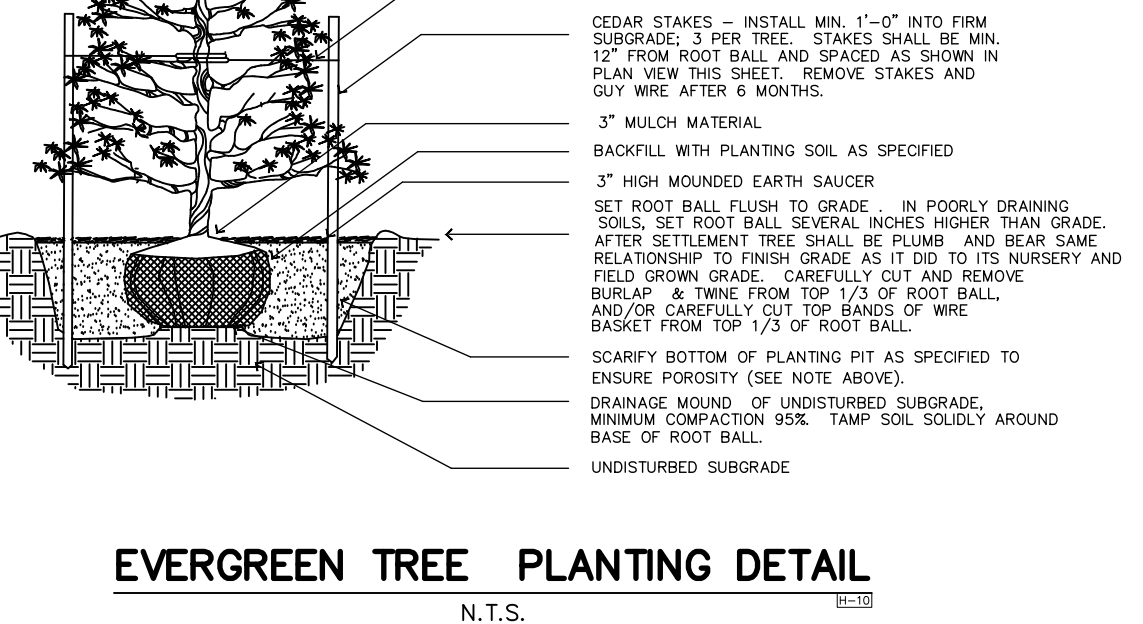
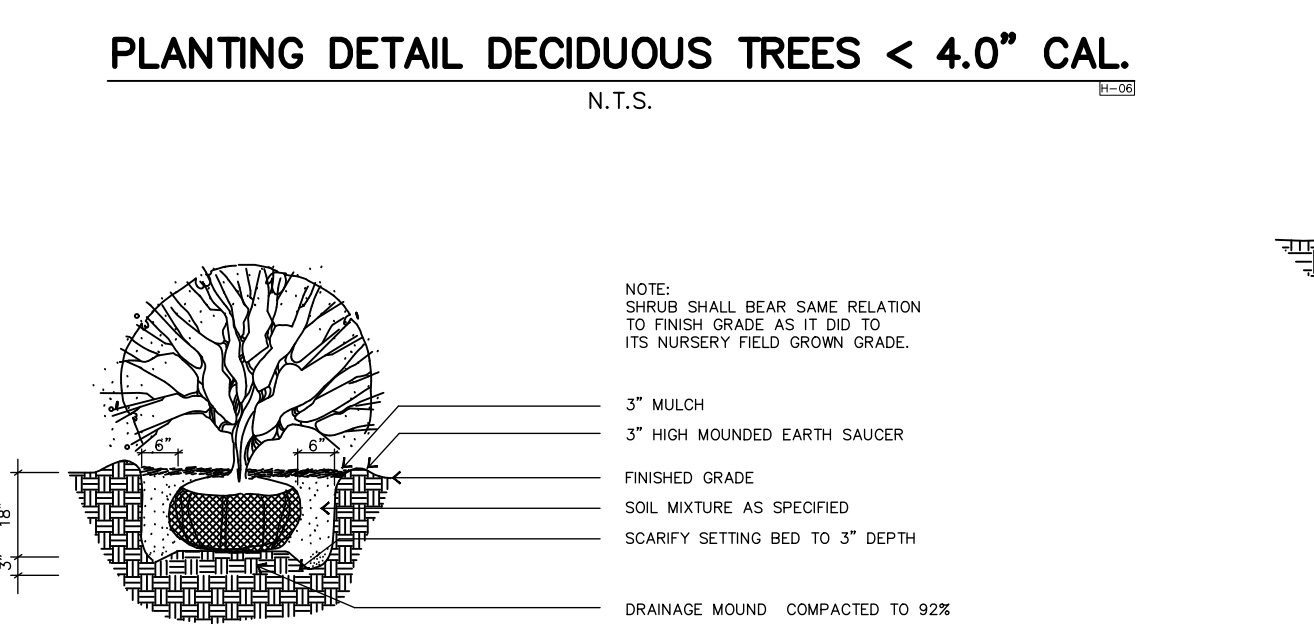
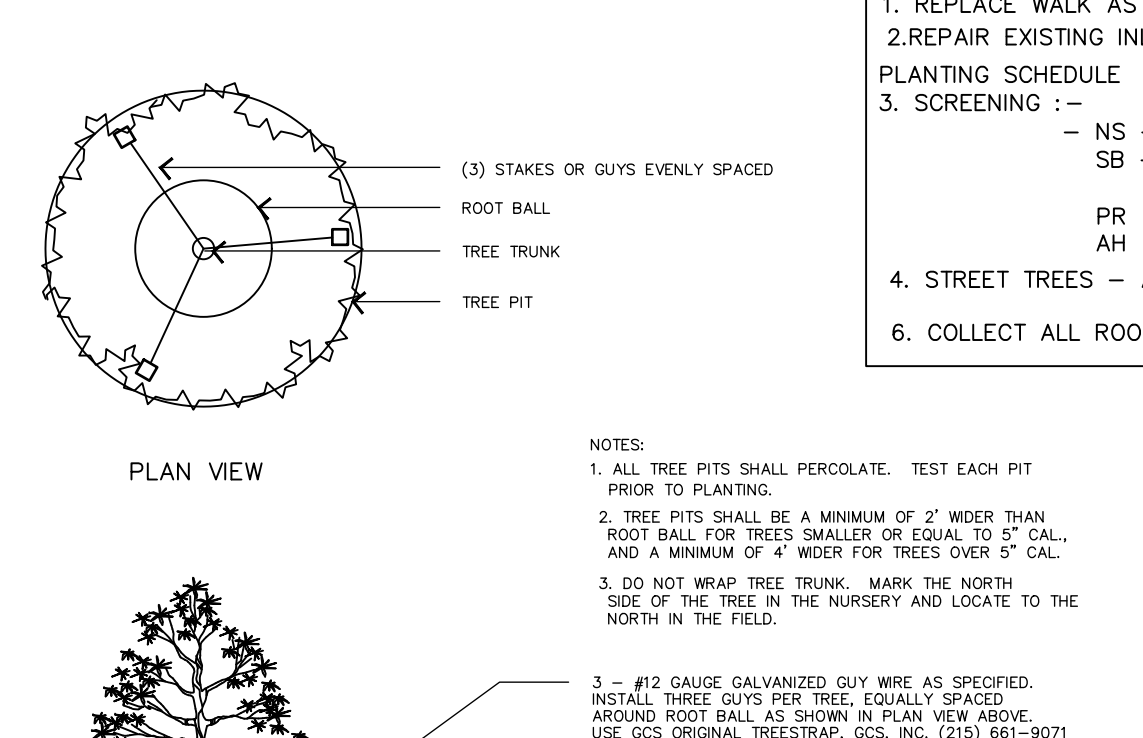
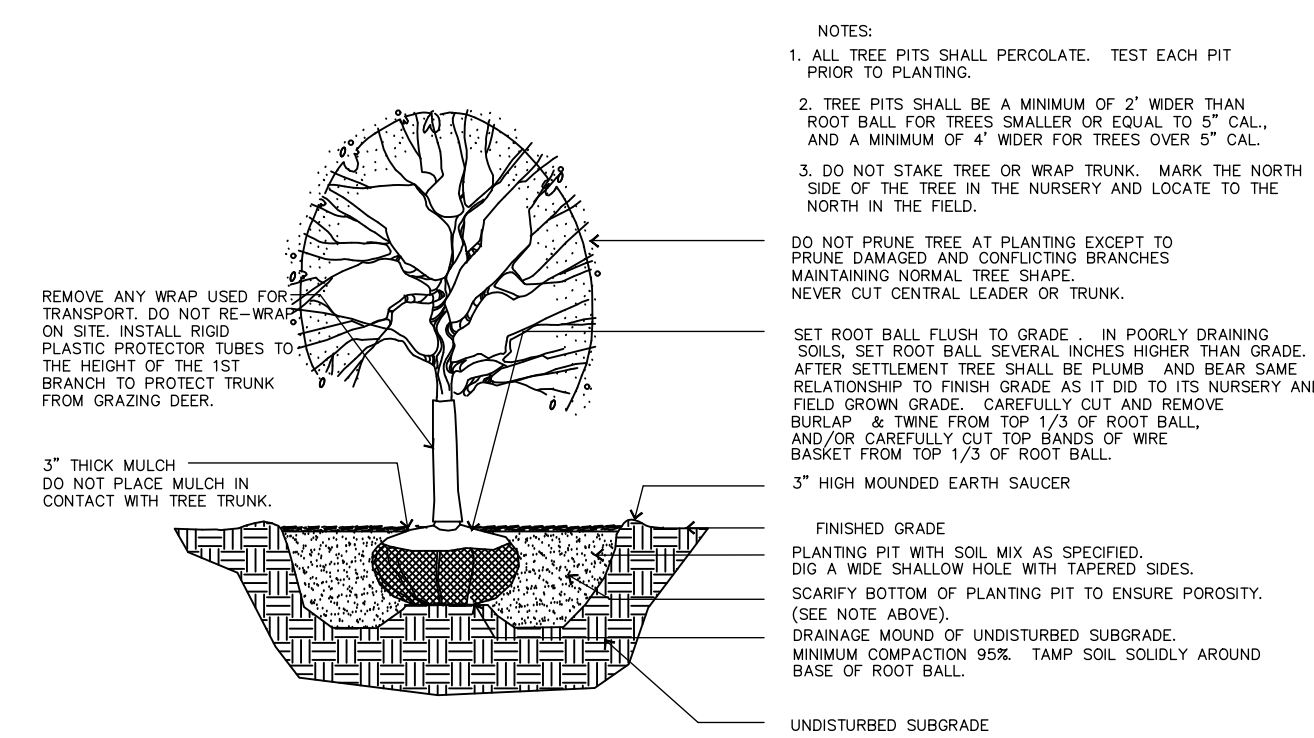

**FFLED26TNW/PCU**

**RAB**

Project: \_\_\_\_\_ Type: \_\_\_\_\_  
 Prepared By: \_\_\_\_\_ Date: \_\_\_\_\_

Driver Info		LED Info	
Type	Constant Current	Watts	26W
120V	0.24A	Color Temp	4000K (Neutral)
208V	0.15A	Color Accuracy	75 CRI
240V	0.13A	L70 LifeSpan	100,000 Hours
277V	0.11A	Lumens	4,043 lm
Input Watts	28.3W	Efficacy	142.9 lm/W

Technical Specifications

**Compliance**  
 UL Listed: Suitable for wet locations. Suitable for mounting within 1.2m (4ft) of the ground.  
 IP Rating: Ingress protection rating of IP66 for dust and water.  
 Title 24 Compliant: An FFLED flood light can be used with a motion sensor or photocell control option to comply with 2016 Title 24 Part 6 Section 1302 (a,b,c).  
 DLC Listed: This product is listed by Design Lights Consortium (DLC) as an ultra-efficient premium product that qualifies for the highest tier of rebates from DLC Member Utilities.  
 Performance: Lifespan: 100,000 Hour LED lifespan based on IES LM-80 results and TM-21 calculations.

**Wattage Equivalency:**  
 Equivalent to 100W Metal Halide  
**Other:**  
 Note: All values are typical (tolerance +/- 10%)  
**Warranty:**  
 RAB warrants that our LED products will be free from defects in materials and workmanship for a period of five (5) years from the date of delivery to the end user, including coverage of light output, color stability, driver performance and fixture finish. RAB's warranty is subject to all terms and conditions found at [rablighting.com/warranty](http://rablighting.com/warranty).  
**Patents:**  
 The FFLED design is protected by U.S. Pat. D643,147; Canada Pat. #67098; China Pat. ZL20113913304.1; Mexico Pat. 36757 and pending patent in Taiwan.  
**Buy American Act Compliance:**  
 RAB values USA manufacturing! Upon request, RAB may be able to manufacture this product to be compliant with the Buy American Act (BAA). Please contact customer service to request a quote for the product to be made BAA compliant.

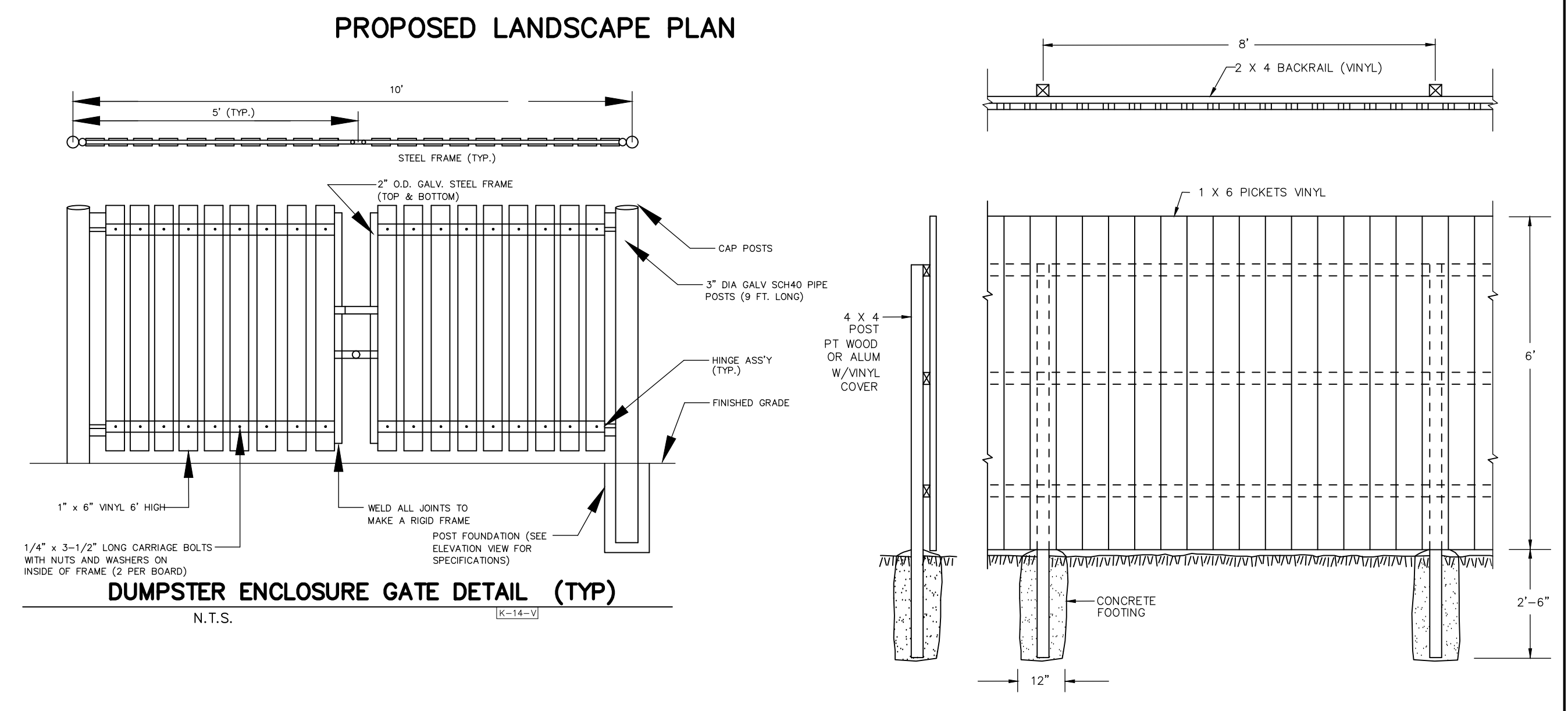
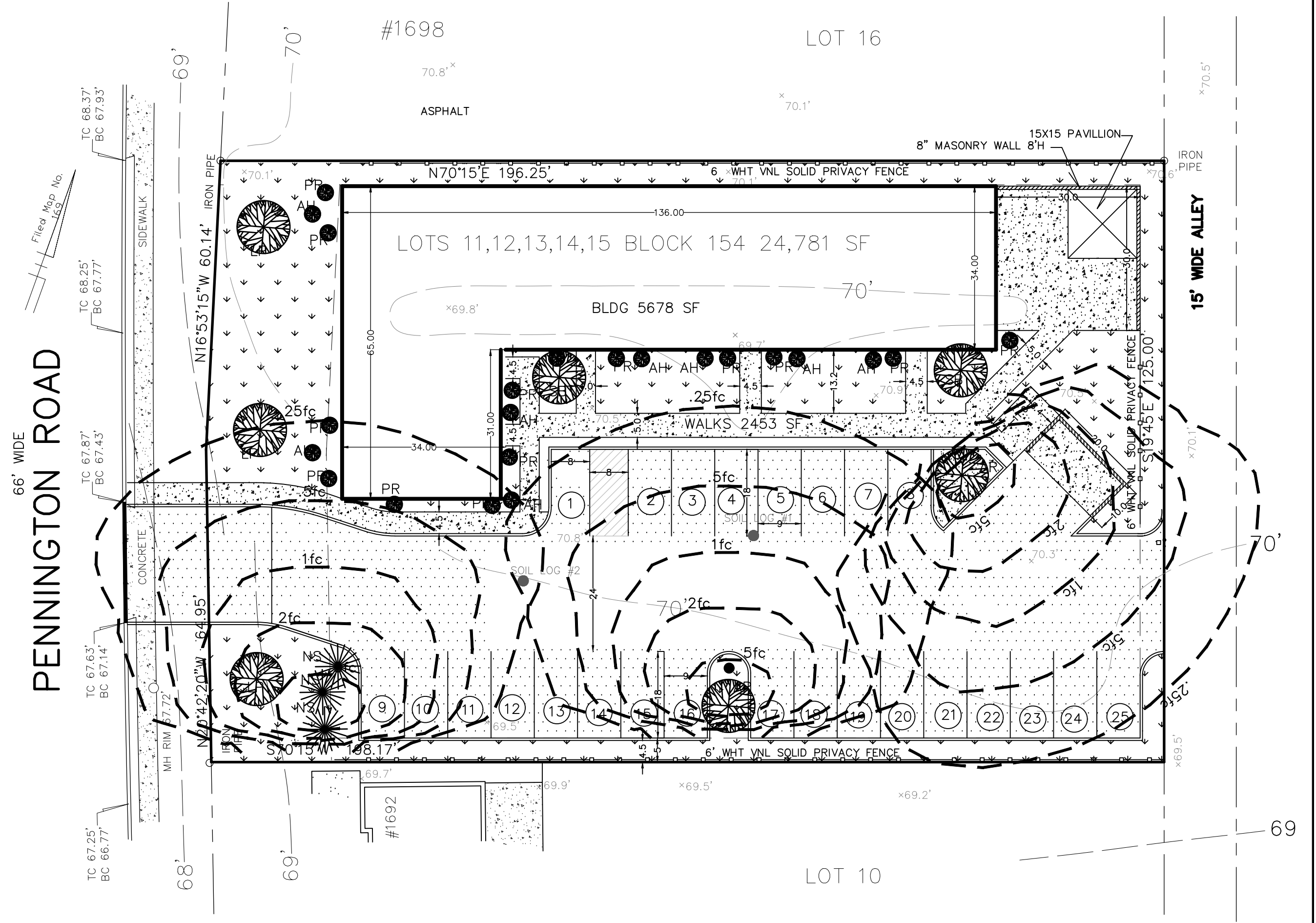
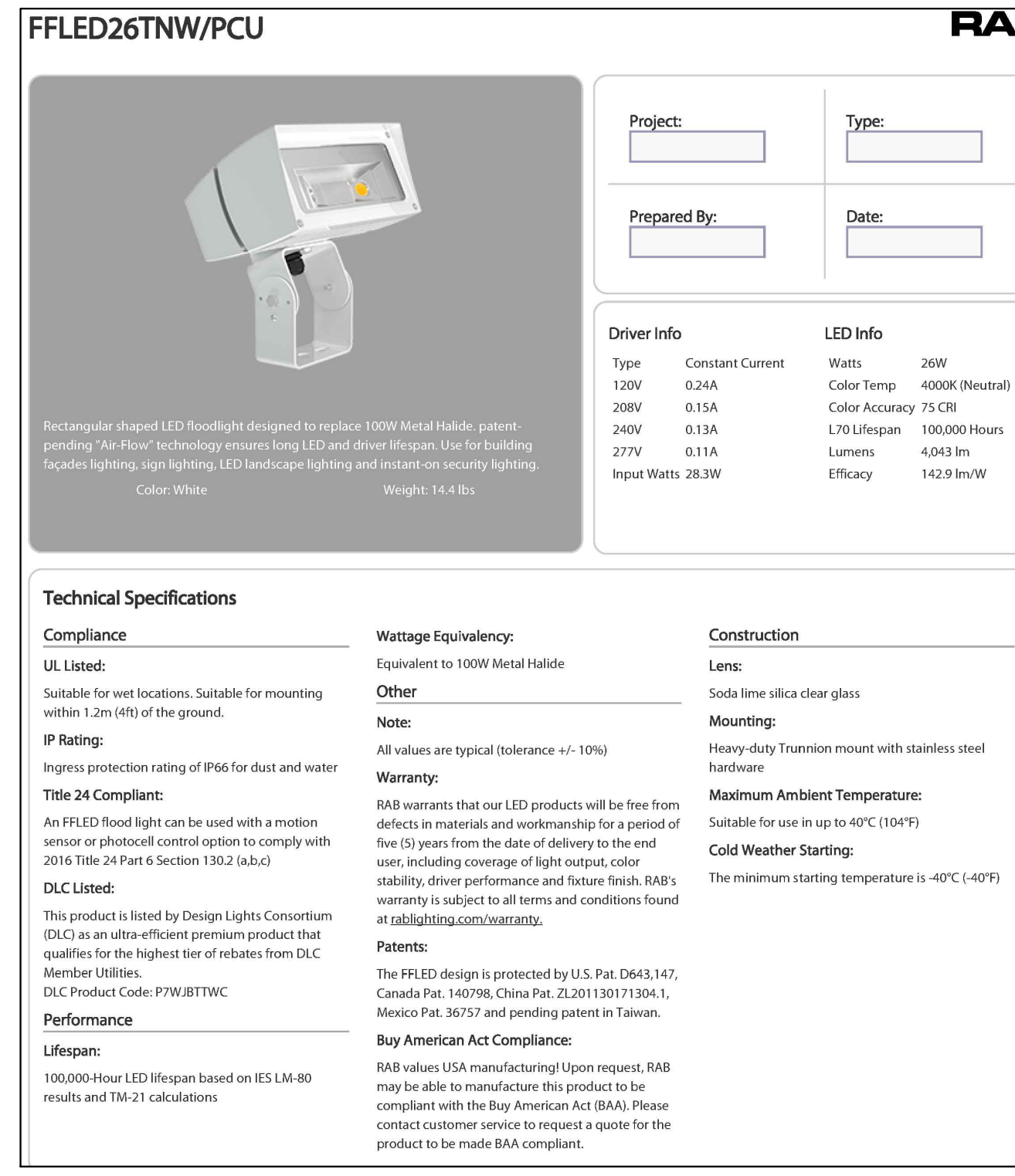

I hereby approve of the filing of this plan as it is in accordance with my desires.

Owner/ Applicant: 1694 PENNINGTON, LLC  
 5435 BROOKSIDE CT  
 DOYLESTOWN, PA 18902

Owner/APPLICANT: ELIZBETH SANOCKI  
 Approved by the Ewing Township Planning Board on \_\_\_\_\_  
 Date: \_\_\_\_\_ APPLIC # \_\_\_\_\_ : RES # \_\_\_\_\_

PLANNING Board Chairman \_\_\_\_\_  
 PLANNING Board Secretary \_\_\_\_\_  
 I hereby certify that all tax payments for this property are current at the time of signing of this plan.  
 Ewing Township Tax Collector \_\_\_\_\_ Date \_\_\_\_\_

2.	PER TWP ENG REVIEW	10/25/24	DCP
1.	CORRECTED ZONING TABLE, MASONRY WALL HGT	06/28/24	DCP
REV.	DESCRIPTION	DATE	BY

**DOUGLAS C. PELIKAN, P.E.**  
 CIVIL & ARCHITECTURAL ENGINEERING  
 1701 PENNINGTON RD. EWING, NJ 08018  
 Phone: (609)865-1596  
 Email: [depelikan@verizon.net](mailto:depelikan@verizon.net)

**LANDSCAPE & LIGHTING PLAN**  
**NEW STUDENT RESIDENCE**  
**LOTS 11,12,13,14,15; BLOCK 154**  
 1694 PENNINGTON RD.  
 TOWNSHIP OF EWING  
 FOR  
**1694 PENNINGTON, LLC.**  
 5435 BROOKSIDE CT., DOYLESTOWN, PA 18902  
 MERCER COUNTY NEW JERSEY  
 SCALE: 1"=20'  
 JAN. 20, 2024  
 DATE SIGNED

**DOUGLAS C. PELIKAN**  
 N.J. LIC. PROFESSIONAL ENGINEER - #BE27632

DRAWN BY: DCP PROJECT NO. DRAWING FILE: SHEET NO. 2 OF 7