

JOSEPH PRIMIANO  
 LIC. NO. 21A01765500

THIS SET OF PLANS IS AN INSTRUMENT OF SERVICE AND IS THE PROPERTY OF THE ARCHITECT. THESE PLANS MAY NOT BE USED FOR ANY OTHER PROJECT NOR REPRODUCED OR COPIED IN ANY MANNER WITHOUT WRITTEN AUTHORIZATION.

REVISIONS

NO.	DESCRIPTION	DATE
1	UPDATE PER TECHNICAL	21/08/2023

PROJECT
BLOCK: 34
LOT: 4B3
331 ROBBINS AVENUE
EWING
MERCER COUNTY
NEW JERSEY

OWNER
FORTI EWING PROPERTIES
110 UNIVERSITY WAY
WEST WINDSOR, NJ 08550

SHEET DESCRIPTION
SITE LIGHTING PLAN

SCALE:
AS NOTED
CHECKED BY: JP
DESIGN BY: TS
DATE: 1/26/2022
JOB NO.: 20220202

S-6

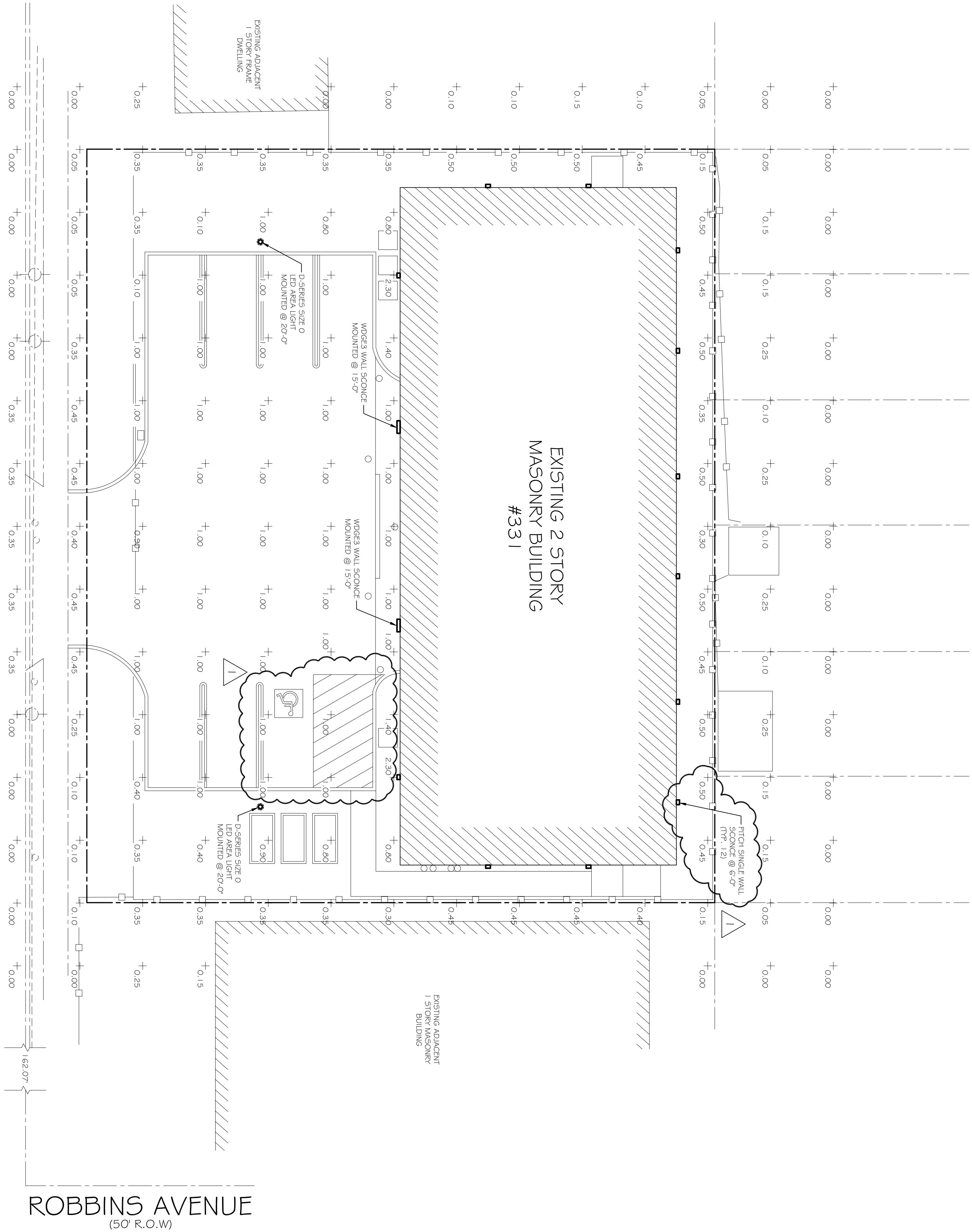

ROBBINS AVENUE  
 (50' R.O.W)

LIGHTING PLAN

SCALE: 1" = 10'-0"

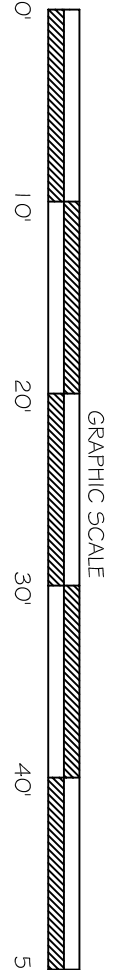

PROPERTY INFORMATION TAKEN FROM PROFESSIONAL LAND SURVEY DATED: 06/20/22 SEALED BY: ANTHONY MATTEO NJ L.S. LIC. NO. 42379

**NOTE**  
 1. COORDINATE MOUNTING HEIGHT OF ALL LIGHTS WITH MORE THAN 0.50 FT AT ALL PROPERTY LINES.