

JOSEPH PRIMIANO  
 LIC. NO. 21A01765500

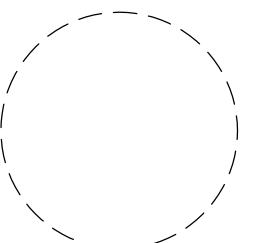

THIS SET OF PLANS IS AN INSTRUMENT OF SERVICE AND IS THE PROPERTY OF THE ARCHITECT. THESE PLANS MAY NOT BE USED FOR ANY OTHER PROJECT NOR WRITTEN AUTHORIZATION.

NO.	DESCRIPTION	DATE
1	UPDATE PER TECHNICAL	2/18/2023

PROJECT	
BLOCK:	34
LOT:	483
331 ROBBINS AVENUE	
EWING	
MERCER COUNTY	
NEW JERSEY	
OWNER	
FORTI EWING PROPERTIES	
110 UNIVERSITY WAY	
WEST WINDSOR, NJ 08550	
SHEET DESCRIPTION	
PROPOSED SITE PLAN AND	
SITE DETAILS	

SHEET DESCRIPTION	
SCALE:	AS NOTED
CHECKED BY:	JP
DESIGNED BY:	TS
DATE:	1/26/2022
JOB NO.:	20220202

SHEET 4 OF 16

SCALE: 1/2" = 1'-0"

### SECTION @ VINYL FENCE

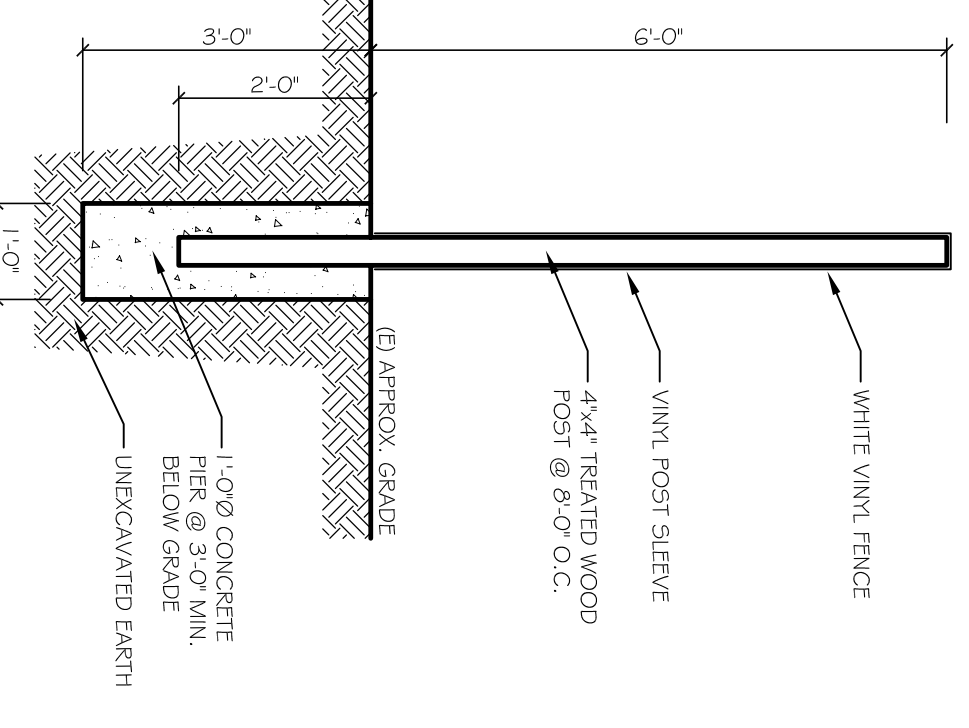

### DETAIL @ SIDEWALK

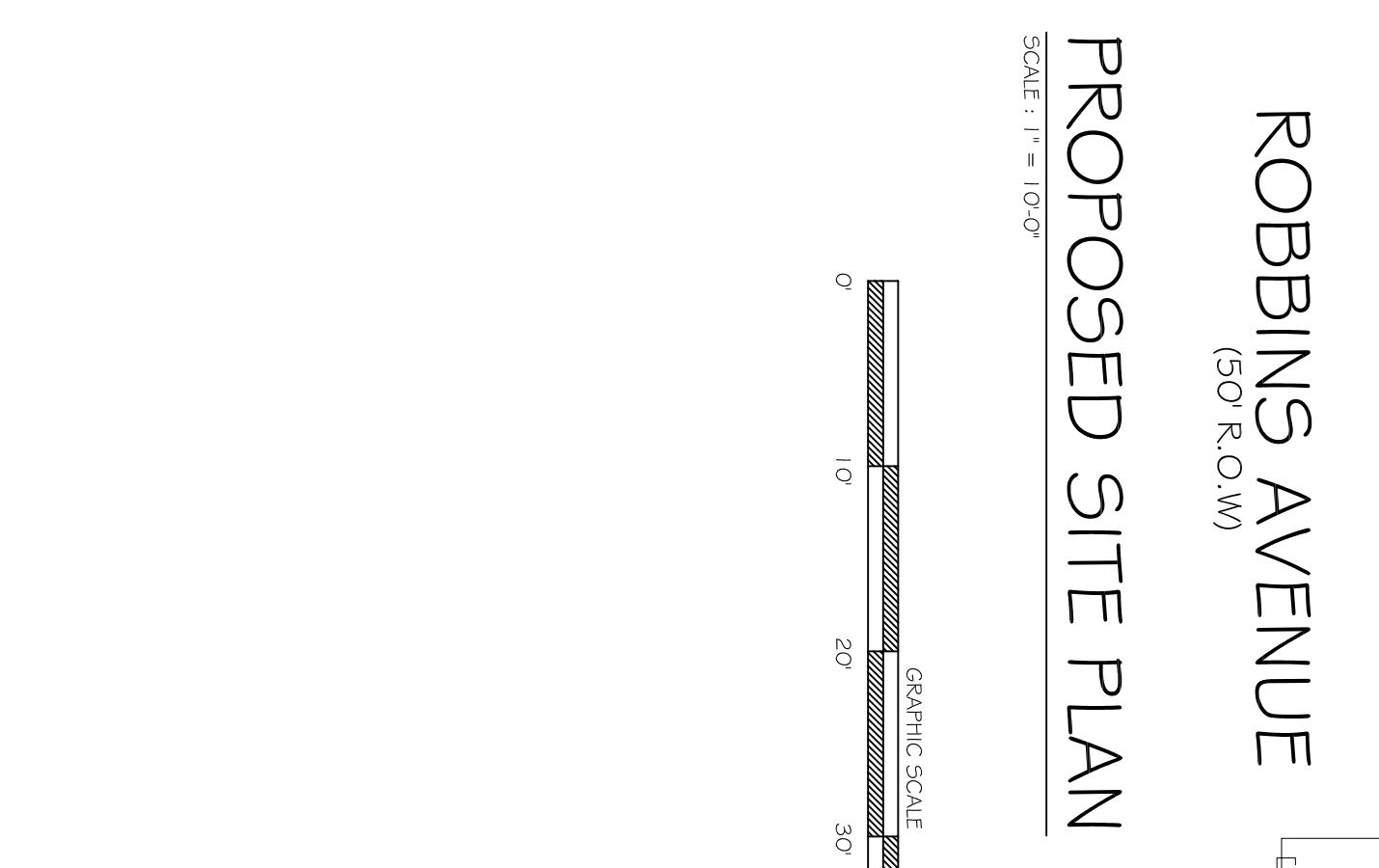
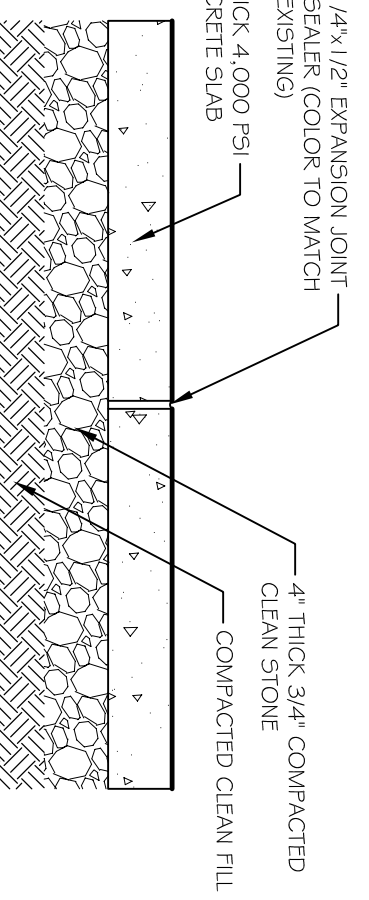

### PROPOSED SITE PLAN

SCALE: 1" = 100'

PROPERTY INFORMATION TAKEN FROM PROFESSIONAL LAND SURVEY SEALED BY PATRICIA MAITSE NJ PLS LIC. NO. 45279

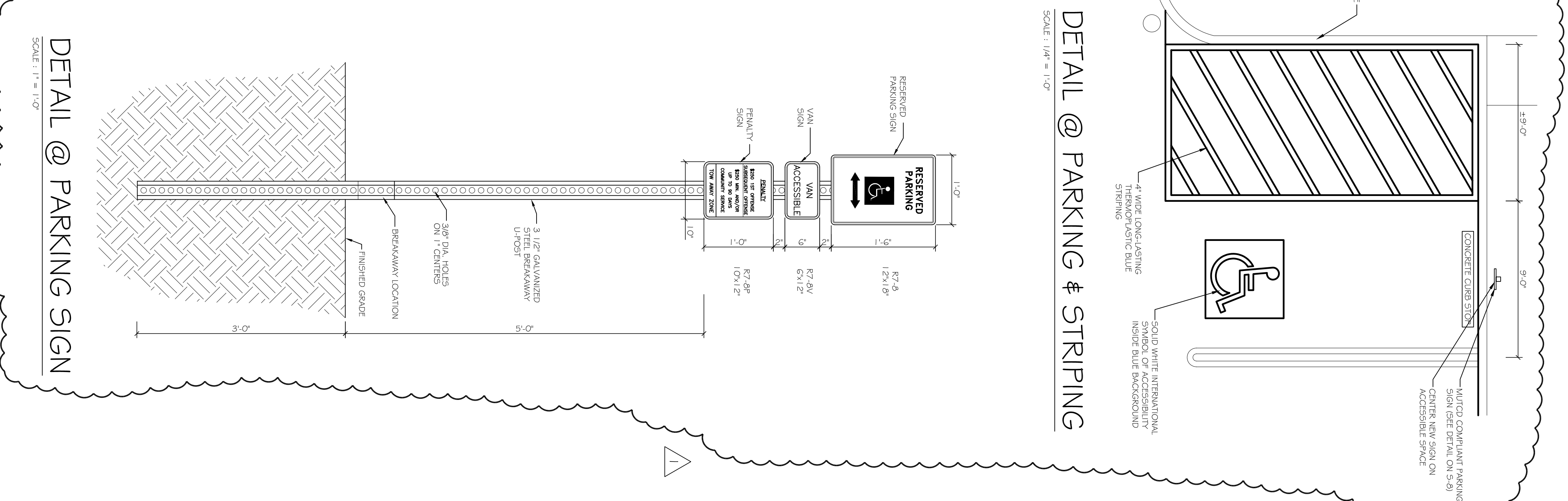

### DETAIL @ PARKING & STRIPING

SCALE: 1/4" = 1'-0"

### DETAIL @ PARKING SIGN

SCALE: 1" = 1'-0"